

## UART – Embedded Optical Area Fingerprint Identification Module

### GTM-5110C2



#### Application :

- ✓ Support **one UART port.**
- ✓ Door Lock , Safety Box, Luggage Lock , Brief Case, Padlock, Remote Controller, Toy, POS, Time Attendance System...etc.

#### Technical Spec:

- MCU *A1 (ARM Cortex M3 core)*
- Sensor *Gingy optical area fingerprint sensor*
- Mechanical dimension (WxLxH) *17 x 37 x 7.5 (mm)*
- Effective sensing area *14 x 12.5 (mm)*
- Resolution *450 dpi*
- Maximum number of fingerprints *20 sets (fingerprints)*
- Interface *UART, default baud rate=9600 bps after power on*
- Matching mode *1:1 ; 1:N*
- The size of template *506 Bytes(template)*
- FAR ; FRR *1/100,000 ; 1/1,000*
- Enrollment time ; Identification time *< 3 seconds. ; < 1.5 second.*
- Fingerprint press shift for free angle *360°*
- Operating temperature *-20°C ~ 60°C*
- Storage temperature & humidity *60°C, 90%±3% RH*
- Operating voltage *DC 3.3V~6V*
- Power consumption *≤ 130 mA*

#### Mechanical Dimension:

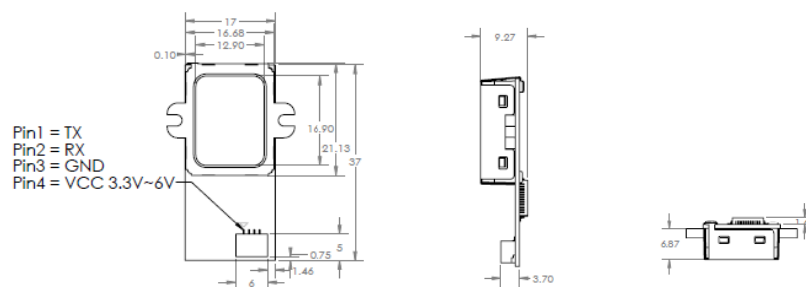

### Key Features:

Convenient & Safe & Facilitation - Just one touch and easy to enroll.

Durable - Resist static electricity and other tough environment.

Small Size is easy to integrate to any portable device.

Stable - Works well with dry, moist or rough fingerprints.

Anti fake fingerprint(option).

High C/P Ratio - Low cost with high performance.

low power consumption.

Finger press shift for free angle

Gingy Technology Inc. ([www.gingytech.com.tw](http://www.gingytech.com.tw))

TEL:886-3-5632500 FAX:886-3-5631189

NO.3, Creation Rd.II, Science Park, Hsin Chu 300, Taiwan, R.O.C.